

A1
1
2
3
4
5
6
7
8
9
10
11

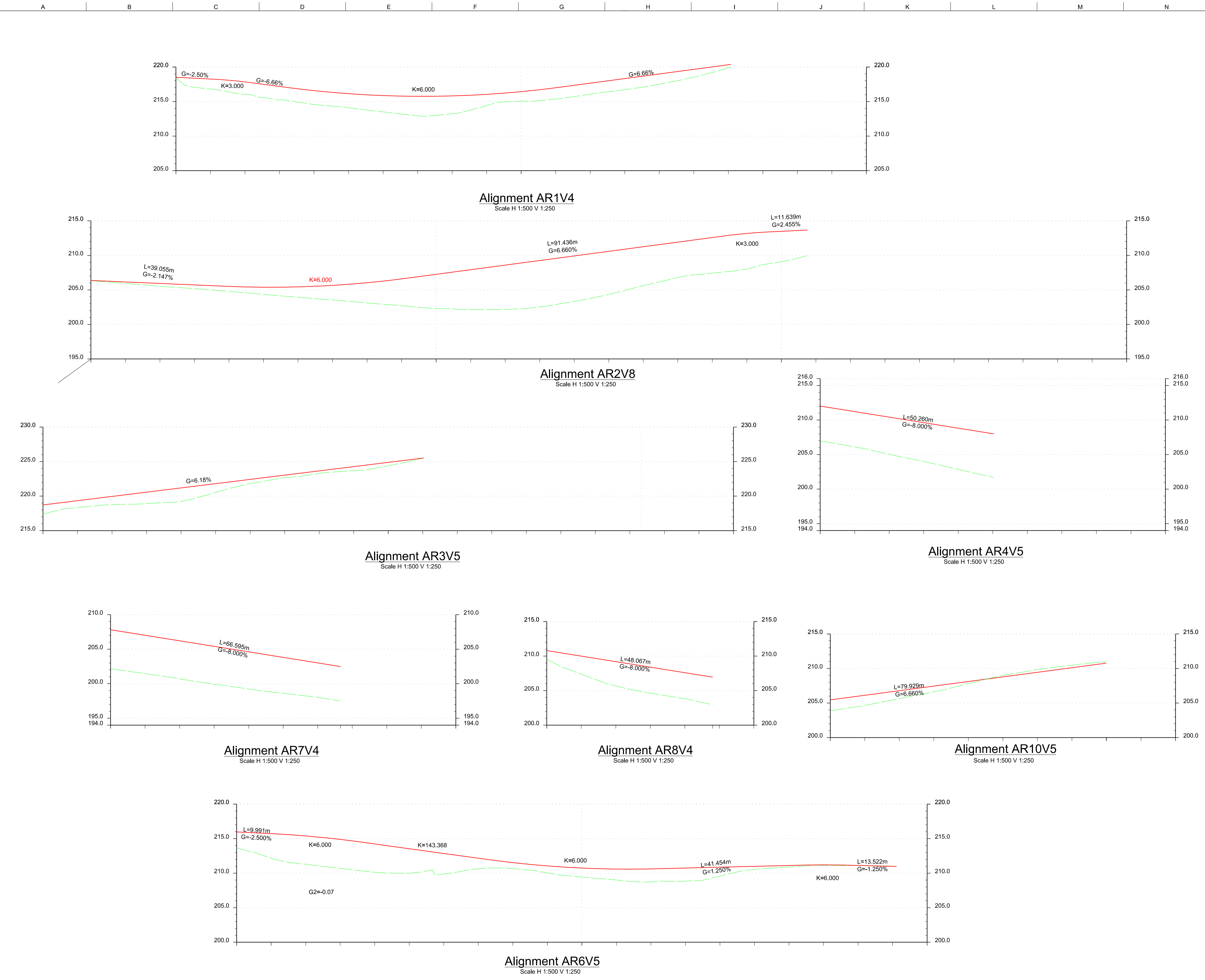

Notes:
1. For alignment locations refer to drawing CH-119.
Key:
--- Existing topography
--- Proposed design

P01	05/10/18	GC	NB	HS
-----	----------	----	----	----

For Information

Rev	Date	By	Chkd	Appd

ARUP
Admiral House, Rose Wharf,
78 East Street, Leeds, LS9 8EE
Tel +44(0)113 242 8498 Fax +44(0)113 242 8573
www.arup.com

Client
The Trustees of Chatsworth Settlement

Project Title
High Shann, Keighley

Drawing Title
Proposed Layout Highway Long Sections

Scale at A1 1:500
Role Civil
Suitability - P01
Arup Job No **259524-00** Rev **P01**
Name **CH-120**